



8 Denmark Drive Orton Waterville Peterborough PE2 5HN

£290,000



*** GUIDE PRICE £290,000 - £300,000 *** NO CHAIN with this modern detached bungalow positioned on a good sized plot and located in Orton Waterville, within easy reach of Waterville Church, Ferry Meadows Country Park, both Primary and Secondary Schools and local shops. The property is in need of some updating. Accommodation comprises three bedrooms, conservatory, UPVC double glazing and gas central heating. Outside are two separate garden areas, a detached single garage and driveway. The property has the potential to extend STPP.



Entrance Hall

Kitchen/Breakfast Room 3.20m (10'6") x 3.13m (10'3")

Lounge/Diner 5.90m (19'4") x 3.50m (11'6")

Conservatory

Bedroom 3 3.21m (10'6") x 2.11m (6'11")

Bedroom 2 3.26m (10'8") x 3.22m (10'7")

Bedroom 1 3.50m (11'6") x 3.22m (10'7")

Bathroom

OUTSIDE

Two separate garden areas, enclosed with timber panelled fencing, laid to lawn, garden shed and paved patio seating areas. Garage with up and over door.

*** If you are considering letting this property for a BUY TO LET please call Fitzjohn Property Rentals on 01733 555520. We can provide you free advice on all aspects of the lettings market including potential rental yields for this property ***

Area Map



Floor Plans

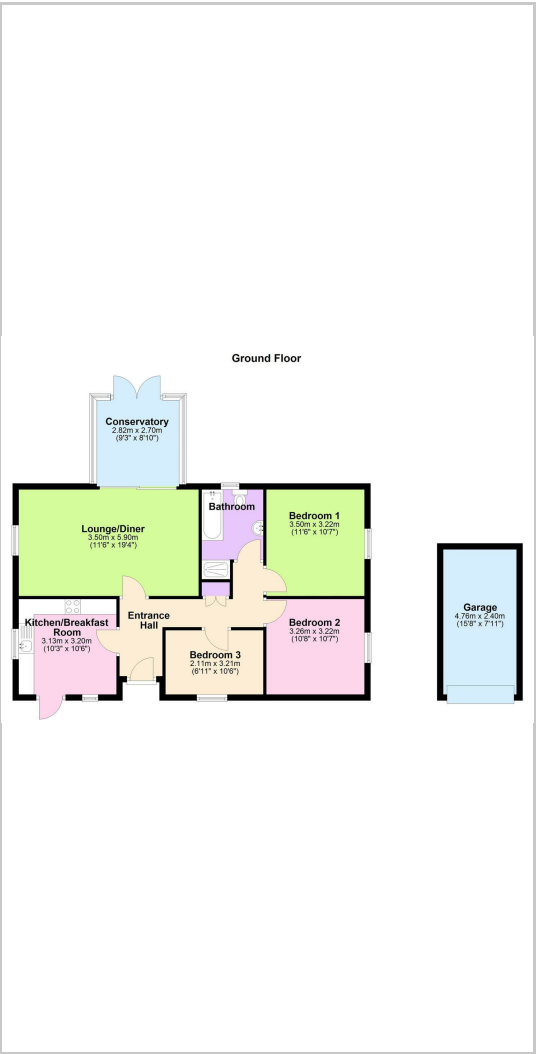

Energy Efficiency Graph

